

LOADING PATTERN MATING SIDE

f	0	0	0	0	0	0	0	0	0	0
e	G	G	G	G	G	G	G	G	G	G
d	A	A	A	A	A	A	A	A	A	A
c	7	7	7	7	7	7	7	7	7	7
b	A	A	A	A	A	A	A	A	A	A
a	G	G	G	G	G	G	G	G	G	G
z	0	0	0	0	0	0	0	0	0	0
POS	01	05	10							

LOADED CONNECTOR ASSEMBLY (FOR EXAMPLE)

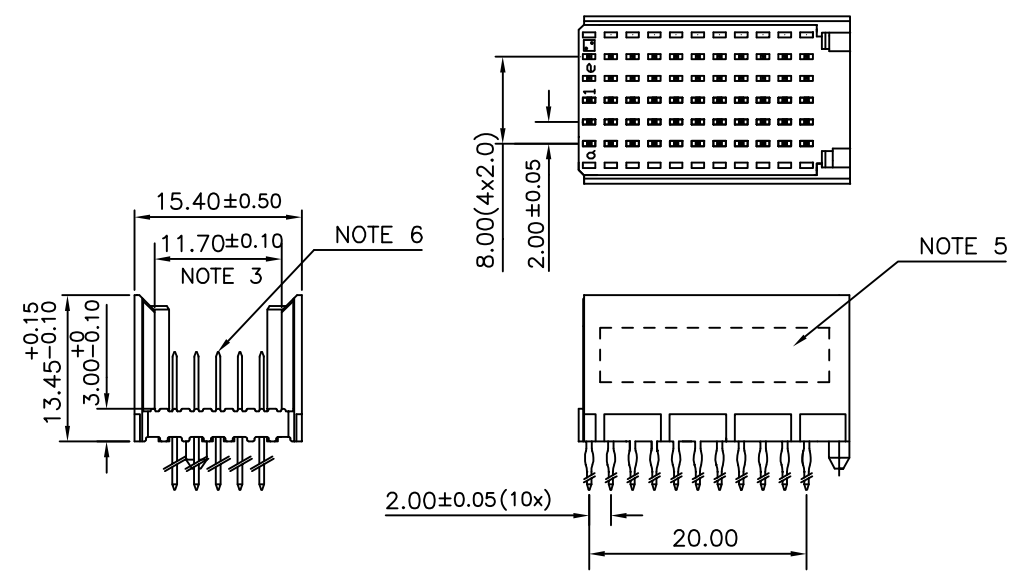

CONTACT OVERVIEW

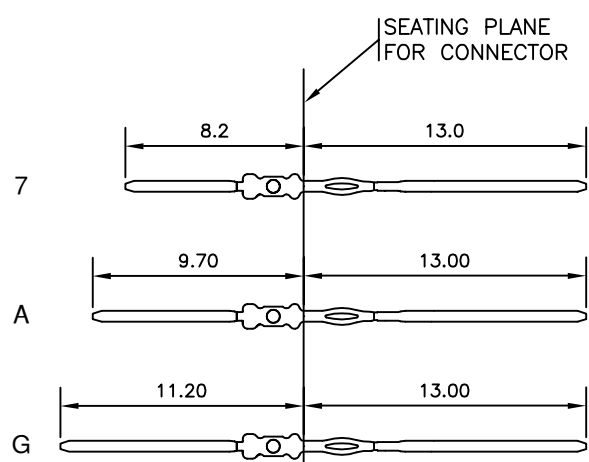

LAY-OUT P.C.B.-HOLE

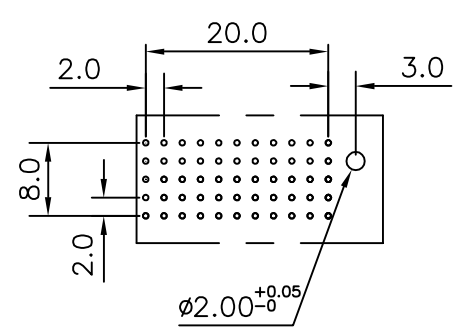

HM2P09PKF1M0 LEAD FREE INDICATOR : LF = LEAD FREE (DIGIT 15 & 16)
 PLATING CODE (DIGIT 13 AND 14) (REF DRW NO. BS,C , 201844 , 003)

NOTES

- THIS PRODUCT IS CSA APPROVED.
 - THIS PRODUCT IS UL RECOGNIZED.
 - MEASURED AT THE BOTTOM.
 - MATERIAL CONTACT: PHOSPHORBRONZE
HOUSING: CREAM WHITE GLASS FILLED POLYESTER UL-94V0
 - CONNECTOR PRINTED WITH P/N AND DATE CODE.
 - FOR ACTUAL CONTACT LOADINGS, SEE LOADING PATTERN MATING SIDE.
 - SHAPE OF CONNECTOR HOUSING CAN ALTER DEPENDING ON PRODUCTION LOCATION
 - THE PRODUCT (LF) MEETS EUROPEAN UNION DIRECTIVES AND OTHER COUNTRY REGULATIONS AS DESCRIBED IN GS-22-008
 - FOR RECOMMENDED PTH DIMENSIONS REFER DRAWING : BS, A , 201572 , 001
- CATALOG NO: HM2P09PKF1M0----

mat'l. code SEE NOTE 4				surface ISO 1302 <input checked="" type="checkbox"/>		tolerance ISO 406 ISO 1101		projection 		product family MILLIPACS	
ltr				ecn no		dr		date		title	
A	105-0005	MINI	2005/01/11	tolerances unless otherwise specified		angles		linear		MM	
B	105-0199	MINI	2005/10/21	.0±0.2		0°±1°				MPACS 5+2R STR HDR PF CONN TYPE C	
C	106-0090	MINI	2006/06/30	.00±0.1						scale -	
				dr		MINI K VANDANATH		2005/01/11		dwg no	
				enr		BIJU K PAUL		2005/01/11		sheet 1 of 1	
				chr		BIJU K PAUL		2006/06/30		size	
				appd		BIJU K PAUL		2006/06/30		A3	
sheet index				revision sheet		C		1		type Product Customer Drawing	

Copyright FCI
 FCI
 FCconnect.com